

HIGH SPEED HUB ASSEMBLIES

IDLER HUBS INCLUDES BEARINGS, CAP, SEAL, & LUG NUTS (OR WHEEL BOLTS WHERE APPLICABLE)



NEW!

Complete Popular Hub Assemblies Available in Attractive Viz-Packs for Retail / Display

86758, 86759, 86760, 86762



2000 lb./pr Capacity Hub with Larger 6.5" Hub Face for 13" wheel applications

NEW!



2500 lbs



3500 lbs

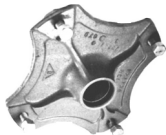

3500-5200 lbs



5200-7000 lbs



NEW!
VIZ-PACK

NEW!
VIZ-PACK

NEW!
VIZ-PACK

PART #	SPINDLE SIZE	BOLT PATTERN	BEARING #'S	MAX. CAPACITY/PR.
8-91-80	1" straight	4H - 4"	L44643 in/out	2000 lbs.
8-91-80M	1" straight	4H - 4"	L44643 in/out	2000 lbs.
8-258-90	1 1/16" straight	5H - 4 1/2"	L44649 in/out	2200 lbs.
8-259-81	1" straight	5H - 4 1/2"	L44643 in/out	2000 lbs.
8-259-81GM	= 8-259-81 Galvanized Hub with HD Seal for Marine Applications ^{BB/EZ}			
8-259-81M	= 8-259-81 supplied less cap, plus HD seal for Marine Applications ^{BB/EZ}			
86758	= 8-259-81 Viz-Packed for Retail / Display			
86759	= 8-259-81GM Viz-Packed for Retail / Display ^{BB/EZ}			
8-91-90	1 1/16" straight	4H - 4	L44649 in/out	2200 lbs.
8-91-90B	= 8-91-90 Boxed for Retail / Display			
8-91-90M	= 8-91-90 supplied less cap, plus HD seal for Marine Applications ^{BB/EZ}			
8-259-90S*	1 1/16" straight	5H - 4 1/2"	L44649 in/out	2200 lbs.
8-259-91	1 1/16" straight	5H - 4 1/2"	L44649 in/out	2200 lbs.
8-259-91B	= 8-259-91 Boxed for Retail / Display			
8-259-91GM	= 8-259-91 Galvanized Hub with HD Seal for Marine Applications ^{BB/EZ}			
8-259-91M	= 8-259-91 supplied less cap, plus HD seal for Marine Applications ^{BB/EZ}			
86760	= 8-259-91 Viz-Packed for Retail / Display			
D12868	3/4" straight	5H - 4 1/2"	LM11949 in/out	2000 lbs.
D17214	1 1/4" x 3/4"	5H - 4 1/2"	LM67048 in/LM11949 out	3000 lbs.
D12842	1 1/4" straight	5H - 4 1/2"	LM67048 in/out	2500 lbs.
8-248-90	1 3/8" x 1 1/16"	5H - 4 1/2"	L68149 in/L44649 out	3500 lbs.
8-248-90B	= 8-248-90 Boxed for Retail / Display			
8-248-90B I	= 8-248-90 Value Priced Manufacturer, Boxed for Retail / Display			
8-248-90GM	= 8-248-90 Galvanized Hub with HD Seal for Marine Applications ^{BB/EZ}			
8-248-90I	= 8-248-90 Value Priced Manufacturer			
8-248-90M	= 8-248-90 supplied less cap, plus HD seal for Marine Applications ^{BB/EZ}			
8-248-90M I	= 8-248-90 Value Priced, supplied less cap, plus HD seal for Marine Use ^{BB/EZ}			
86762	= 8-248-90 Viz-Packed for Retail / Display			
8-248-92	1 3/8" x 1 1/16"	5H - 4 3/4"	L68149 in/L44649 out	3500 lbs.
8-256-91	1 3/8" x 1 1/16"	5H - 5"	L68149 in/L44649 out	3500 lbs.
8-256-90	1 3/8" x 1 1/16"	5H - 5 1/2"	L68149 in/L44649 out	3500 lbs.
8-251-90	1 3/8" x 1 1/16"	6H - 5 1/2"	L68149 in/L44649 out	3500 lbs.
8-246-90	1 3/8" x 1 1/16"	4H - 9.44"	L68149 in/L44649 out	3500 lbs.
8-261-90	1 3/8" x 1 1/4"	5 spoke UTG	L68149 in/LM67048 out	4000 lbs. (MH)
8-213-90	1 3/4" x 1 1/4"	6H - 5 1/2"	25580 in/LM67048 out	5200 lbs.
8-213-90M	1 3/4" x 1 1/4"	6H - 5 1/2"	25580 in/LM67048 out	5200 lbs.
8-157-90	1 3/4" x 1 1/4"	4H - 9.44"	25580 in/LM67048 out	5200 lbs.
8-231-92	1 3/4" x 1 1/4"	8H - 6 1/2"	25580 in/14124A out	7000 lbs.

* Short back-to-back race dimensions

^{BB/EZ} #1980A Bearing Protector or #21-41 EZ Lube Cap & Plug Recommended - Please order separately

HUBS & DRUMS



HUBS & DRUMS ONE PIECE UNIT INCLUDES BEARINGS, CAP, SEAL, & LUG NUTS

NEW!

We Now Stock Disc Brake Components! See page 16



2200 lbs



3500 lbs



(Not designed for water immersion)

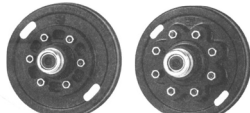

4000-7000 lbs



PART #	BRAKE SIZE	BOLT PATTERN	BEARING #'S	MAX. CAPACITY/PR.
8-257-90	7" X 1 1/4" elec.	5H - 4 1/2"	L44649 in/out	2200 lbs.
8-271-90	7" X 1 3/4" hydr. only	5H - 4 1/2"	L44649 in/out	2200 lbs.
8-252-90	7" X 1 3/4" hydr. only	5H - 4 1/2"	L68149 in/L44649 out	3500 lbs.
D15445	8 1/2" x 2 1/4" hydr.	5H - 4 1/2"	L68149 in/L44649 out	3500 lbs.
8-247-90	10" x 2 1/4" elec/hydr.	5H - 4 1/2"	L68149 in/L44649 out	3500 lbs.
8-247-90 I	= 8-247-90 Value Priced Manufacturer			
8-247-90 M	= 8-247-90 supplied less cap, plus HD seal for Marine Applications ^{BB / EZ}			
8-247-90 MI	= 8-247-90 Value Priced, supplied less cap, plus HD seal for Marine Use ^{BB / EZ}			
8-249-91	10" x 2 1/4" elec/hydr.	5H - 5"	L68149 in/L44649 out	3500 lbs.
8-245-90	10" x 2 1/4" elec/hydr.	4H - 9.44"	L68149 in/L44649 out	3500 lbs.
8-249-90	10" x 2 1/4" elec/hydr.	5H - 5 1/2"	L68149 in/L44649 out	3500 lbs.
8-250-90	10" x 2 1/4" elec/hydr.	6H - 5 1/2"	L68149 in/L44649 out	3500 lbs.
8-222-90	12" x 2" elec/hydr.	5 spoke UTG	L68149 in/LM67048 out	4000 lbs. (MH)
8-201-90	12" x 2" elec/hydr.	6H - 5 1/2"	25580 in/LM67048 out	5200 lbs.
8-201-90 I	= 8-201-90 Value Priced Manufacturer, uses 15123 outer bearing			
8-201-90 M	= 8-201-90 supplied less cap, plus HD seal for Marine Applications ^{BB2 / EZ2}			
8-201-90 MI	= 8-201-90I Value Priced, less cap, plus HD seal for Marine Use ^{BB2 / EZ2}			
8-155-90	12" x 2" elec/hydr.	4H - 9.44"	25580 in/LM67048 out	5200 lbs.
8-174-90	12" x 2" elec/hydr.	5 spoke UTG	25580 in/15123 out	6000 lbs.
8-219-90	12" x 2" elec/hydr.	8H - 6 1/2"	25580 in/ 14125A out	7000 lbs.
8-219-90 I	= 8-219-90 Value Priced Manufacturer			
8-219-91*	12" x 2" elec/hydr.	8H - 6 1/2"	25580 in/ 14125A out	7000 lbs.
8-385-91	12" x 2" elec/hydr.	8H - 6 1/2"	Fits Dexter 50mm Nev-R-Lube Axle	
8-218-90	12 1/4" x 3 3/8" elec/hydr.	8H - 6 1/2"	25580 in/ 02475 out	8000 lbs.
8-285-90**	12 1/4" x 3 3/8" elec/hydr.	8H - 6 1/2"	25580 in/ 02475 out	8000 lbs.

* hub & drum with 9/16" studs, 8-219-90 uses 1/2" studs

** hub & drum with 4.75 hub pilot (new style), 8-218 has 4.56 pilot (old style), both w/5/8" studs

^{BB / EZ} #1980A Bearing Protector or #21-41 EZ Lube Cap & Plug Recommended - Please order separately

^{BB2 / EZ2} #2441 Bearing Protector or #21-42 EZ Lube Cap & Plug Recommended - Please order separately

HUBS & DRUMS (2 PIECE HUB & DRUMS WITH BEARINGS, CAP, SEAL, & LUG NUTS) - HUBS SPECIAL ORDER - DRUMS IN STOCK

Assembly					Drum
8-288-90	12 1/4" x 3 3/8"	8H - 6 1/2"	387A in/25580 out	9 & 10k GD	9-44-1
8-214-90	12 1/4" x 4"	8H - 6 1/2"	395S in/387A out	10k HD	9-27-1
8-214-95	12 1/4" x 5"	8H - 6 1/2"	3984 in/28682 out	12k	9-28-1
8-217-90	12 1/4" x 5"	8H - 6 1/2"	3984 in/28682 out	15k	9-28-1
8-277-90	12 1/4" x 7 1/2"	10H - 8 3/4"	HM218248 in/HM212049 out	20k	9-40-1

MOBILE HOME HUB / DRUM

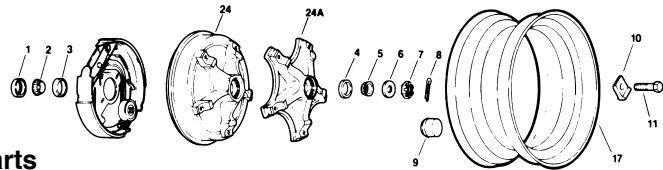

Standard Grease Lube Parts

ITEM	PART NO.	DESCRIPTION	ITEM	PART NO.	DESCRIPTION
1	10-41	Nylon Grease Seal	6	5-27	Spindle Washer
2	31-33-2	Inner Bearing Cone, L68149	7	6-1	Spindle Nut
3	31-33-1	Inner Bearing Cup, L68111	8	19-2	Cotter Pin
4	31-32-1	Outer Bearing Cup, LM67010	9	21-1	Grease Cap
5	31-32-2	Outer Bearing Cone, LM67048	10	15-2	Rim Clamp
			11	7-36	1/2 -13 Wheel Bolt

Wheels & Rims

ITEM	PART NO.	DESCRIPTION
17-32	992834	14.5 x 6.00 MH Rim (Heavy)
17-48	992836	14.5 x 7.00 MH Rim

Idler Hub/Hub & Drum

ITEM	PART NO.	DESCRIPTION	BOLT
24	8-261-4	Idler w/cups	Demountable
24	8 222-4	Hub & Drum w/cups	Demountable



Mobile Home Brakes are available as parts only. See page 19

WHEEL & HUB PARTS • SPINDLES / BEARINGS

NEW!

Removable Spindles



NEW!

NEW!

NEW!

SPINDLES, SPINDLE WASHERS, SPINDLE NUTS

PART #	DESCRIPTION	FITS
2-160-1	1" Straight Spindle Assy., 2000 lb. axles	1 1/4" I.D. Tube
2-160-4	1 1/16" Straight Spindle Assy., 2000 lb. axles	1 1/4" I.D. Tube
80323	1 1/16" Replacement Removable Straight Spindle for Tie-Down, Torflex 2K Axles	
2-160-2	1 1/4" Straight Spindle Assy., 2500, 3000 lb. axles	1 1/2" I.D. Tube
2-162-7	1 3/8"-1 1/16" Step Spindle Assy., 3500 lb. axles	1 3/4" I.D. Tube
80324	1 3/8"-1 1/16" Replacement Removable Step Spindle for Tie-Down, Torflex 3.5K Axles	
2-162-22	1 3/8"-1 1/16" Step Spindle Assy., w/E-Z lube, 3500 lb. axles	1 3/4" I.D. Tube
2-161-7	1 3/4"-1 1/4" Step Spindle Assy., 5.2-7K axles	2 1/4" I.D. Tube
2-161-22	1 3/4"-1 1/4" Step Spindle Assy., w/E-Z lube, 5.2-7K axles	2 1/4" I.D. Tube
80062A	1 3/4"-1 1/4" Replacement Removable Step Spindle for Tie-Down, Torflex 5.2-7K Axles	
2-MH-1	1 3/8"-1 1/4" Step Spindle Assy., For Motor Home Axle Applications	

Note: The above are complete with nut, cotter pin & washer (where necessary)



PART#	DESCRIPTION
5-22	round washer, 3/4" ID, 2k-6k axles
5-23	"D" style washer, 1" ID, 2k-6k axles
5-27**	round washer, 1" ID 2k-6k axles
5-101	tang washer for Dexter E-Z lube 2k-7k
5774	one round washer & one castle nut, 1"-14 spindle thread -viz pack
5775	one "D" style washer & one castle nut, 1"-14 spindle thread-viz pack
5-57	"D" style washer, 2 1/2" OD x 1"ID, 6-9k Dexter axles
5-59	tang washer, 1 3/4" ID, Dexter 12-15k
5-60	keyed washer, 1 3/4"ID for 1 3/4"-12 spindle, 10-15k axles

**note : 1" keyed or "tongue" washer NLA, use round washer in its place

PART#	DESCRIPTION
6-1	6 slot castle nut, 1"-14 thread, 2k-9k axles
6-2	6 slot castle nut, 3/4"-14 thread, 2k-9k axles
6-176	12 slot castle nut, 1"-14 thread, 2k-9k axles - DISCONTINUED, Use 6-1
6-84	spindle nut, 1 3/4"-12 thread, 10k-15 axles
6-190	new style retainer - use with 6-191
6-191	new style jam nut - use with 6-190

BULK BEARINGS



BEARING#	DEXTER#	I.D. OF BRG	AXLE CAPACITY	CUP#
LM11949	NLA	3/4"	2k inner/outer	use w/LM11910 cup
L44643	31-31-3	1"	2k inner/outer	use w/L44610 cup
L44649	31-31-2	1 1/16"	2k inner/outer & 3.5k outer	use w/L44610 cup
LM67048	31-32-2	1 1/4"	4(MH), 5.2 & 6k outer	use w/L67010 cup
15123	31-29-2	1 1/4"	5.2, 6, & 7k outer	use w/15245 cup
14125A	31-17-2	1 1/4"	5.2-7k outer	use w/14276 cup
02475	31-28-2	1 1/4"	7.2, 7.5, & 8kouter	use w/02420 cup
L68149	31-33-2	1 3/8"	3.5 & 4k(MH) inner	use w/L68111 cup
LM48548	31-08-2	1 3/8"	inner	use w/LM48510 cup
25580	31-30-2	1 3/4"	5.2-9k inner, 9 & 10k outer	use w/25520 cup
387A	31-19-2	2 1/4"	9 & 10k inner, 10k outer	use w/382A cup
395S	31-22-2	2 5/8"	10k inner	use w/394A cup
3984	31-20-2	2 5/8"	12 & 15k inner	use w/3920 cup
28682	31-21-2	2 1/4"	12 & 15k outer	use w/28622 cup
2585	31-25-2	1.3"	9 & 10k outer (older)	use w/2520 cup
31-72-3	31-72-3	35mm	3.5K Nev-R-Lube Sealed Cartridge Bearing Pack	
31-73-3	31-73-3	42mm	5.2K Nev-R-Lube Sealed Cartridge Bearing Pack	
31-71-3	31-71-3	50mm	6.7K Nev-R-Lube Sealed Cartridge Bearing Pack	



NEW!

NEV-R-LUBE
SEALED CARTRIDGE BEARING SYSTEM

BLISTER - PACKED BEARING SETS (ONE CONE & ONE CUP)

PART#	DESCRIPTION
5502	L44649 cone & L44610 cup
5503	25580 cone & 25520 cup
5505	L68149 cone & L68111 cup
5506	48548 cone & 48510 cup
5507	LM67048 cone & LM68010 cup
5508	14125A cone & 14276 cup
5509	15123 cone & 15245 cup



WHEEL & HUB PARTS • BEARING KITS / GREASE CAPS



WHEEL BEARING KITS

(INCLUDES 2 BEARINGS, 2 RACES, 1 SEAL, 1 DUST CAP)



PART#	DESCRIPTION
WB750	LM11949 cone/LM11910 cup for 3/4" straight spindles
WB100	L44643 cone/L44610 cup for 1" straight spindles
WB106	L44649 cone/L44610 cup for 1 1/16" straight spindles
WB125	LM67048 cone/67010 cup for 1 1/4" straight spindles
WB125T	LM67048 / 67010 & LM11949 / LM11910 for 1 1/4" x 3/4" step spindles
WB138T	L68149 & L44649 cones (with cups) for 1 3/8" x 1 1/16" step spindles
WB8-174	25580 & 15123 cones (5 Spoke UTG Hub) for 1 3/4" x 1 1/4" step spindles
WB8-219	25580 & 14125A cones (8 Spoke Hub) for 1 3/4" x 1 1/4" step spindles
WB8-222	LM67048 & L68149 cones (5 Spoke UTG MotorHome Hub Application)



STEEL "PRESS IN" GREASE CAPS

PART#	O.D. OF CAP	APPLICATION
075-01	1.78"	fits hubs with 3/4" outer bearing (LM11949)
21-3	1.98"	fits 2 & 3.5k axles w/L44643 or L44649 outer brg
125-01	2.33"	fits hubs with 1 1/4" outer bearing (L67048)
21-1	2.44"	fits 5.2 & 6k 655 axles w/15123 or 67048 outers fits 6 & 7k UTG axles w/15123 outer bearings
21-39	2.72"	fits 6-7k 865 axles w/14125A outer bearings fits 7.2 & 8k 865 axles w/02475 outer bearings
21-41	1.98"	Cap w/ 85-1 plug - fits same as 21-3, for E-Z lube axles
71-315	1.98"	2 Caps with plugs - Display Packaged on Card
21-41-1	1.98"	Cap only, fits same as 21-3, for E-Z lube axles
21-42	2.44"	Cap w/ 85-1 plug - fits same as 21-1, for E-Z lube axles
71-317	2.44"	2 Caps with plugs - Display Packaged on Card
21-42-1	2.44"	Cap only, fits same as 21-1, for E-Z lube axles
21-43	2.72"	Cap w/ 85-1 plug - fits same as 21-39, for E-Z lube axles
71-319	2.72"	2 Caps with plugs - Display Packaged on Card
21-43-1	2.72"	Cap only, fits same as 21-39, for E-Z lube axles
85-1		Removable rubber replacement plug for E-Z lube axles
5651	1.98"	2 - 21-3 grease caps (viz pack)
5652	2.44"	2 - 21-1 grease caps (viz pack)
21-84		fits Nev-R-Lube #8-386 - 3.5k 6 stud hub & drum with 35mm bearing pack
21-85		fits Nev-R-Lube #8-388 - 5.2k 6 stud hub & drum with 42mm bearing pack
21-86		fits Nev-R-Lube #8-385 - 6k-7k 8 stud hub & drum with 50mm bearing pack

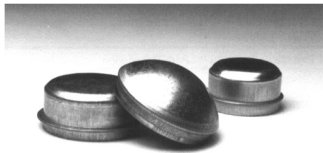

NEW!



SCREW-ON OIL CAP KITS

(COME COMPLETE WITH O-RING & PLUG WHERE APPLICABLE)



PART#	DESCRIPTION	APPLICATION
71-37	Dexter 21-40 oil cap & O-ring	6 & 7k oil bath UTG axles
71-38	(1 Pair) Dex. 21-35 oil cap, 10-45 O-ring, 46-32 plug	8-9k oil bath 865 s w axles
71-39	Dexter 21-37 oil cap	NLA -use 71-148
71-148	(1 Pair) Dex. 21-36 oil cap, 10-50 O-ring, 46-32 plug	10-15k oil bath axles
71-150	Hayes oil cap, O-ring, & plug, 3.75 OD	9-16k oil bath axles
71-151	AL-KO & Hayes oil cap, O-ring, & plug	8k oil bath axles

BOLT-ON OIL CAP KITS

PART#	DESCRIPTION	APPLICATION
21-38-2	universal oil cap, 6 bolt, 5 1/2" bolt circle	20-25 air brake axles
71-124	gasket for above cap	

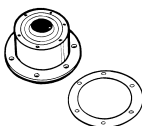

GREASE & OIL SEALS - BULK



OD X ID OF SEAL		
PART#	(INCHES)	APPLICATION
075-02	1.812 x 1.125	grease, use w/LM11949 inner (3/4" straight spindle)
125-02	2.33 x 150	grease, use w/LM67048 inner (1-1/4" straight or 1-1/4" x 3/4" tapered)
10-1	3.373 x 2.125 single lip	grease, use w/25580 inner brg - Dexter 5.2-7k axles
10-3	1.987 x 1.25	grease, use w/L44643 inner brg (1" straight spindle)
10-3DL	1.987 x 1.25 double lip	grease, use w/L44643 inner brg (1" straight spindle)
10-4	2.565 x 1.718	grease, use w/L68149 inner brg - Dexter 3.5k axles
10-9	1.987 x 1.50	grease, use w/L44649 inner brg - Dexter 2k axles
10-10	3.376 x 2.125 double lip	grease, use w/25580 inner brg - Dexter 5.2-7k axles
10-19	2.565 x 1.718 double lip	grease, use w/L68149 inner brg - Dexter 3.5k axles
10-40	2.51 x 1.938	grease, use w/68149 inner mobile home axle(MHU)
10-41	2.523 x 1.938	grease, same as above, nylon instead of steel
10-42	2.33 x 1.75	grease, use w/LM67048 inner brg-Dexter 2.8k axles
10-47	3.376 x 2.25	double lip grease, use w/ 25580 inner-Dexter (after 1997) 5.2-7k & non Dexter 6k (= #10-36)
10-48	3.376 x 2.375	double lip oil, use w/ 25580 inner-Dexter 7.5 & 9k "old" style (up to 10/89) axles
10-51-1	3.88 x 2.875	unitized oil, use w/ 387A inner-Dexter 9 & 10k gd
10-54	3.376 x 2.25	single lip grease, use w/ 25580 inner-Dexter (after 1997) 5.2-7k & non Dexter 6k (can use #10-47)
10-56	4.506 x 3.125	unitized oil, use w/ 395S & 3984 inners-Dexter 10,12, & 15k axles
10-60	1.987 x 1.50 double lip	grease, use w/L44649 inner brg - Dexter 2k axles
10-63	3.376 x 2.25	unitized oil, use w/ 25580 inner-Dexter 8k & 9k"old style" (up to 10/89) axles



PART#	BULK SEAL EQUIVALENT	
5602	10-3	
5603	10-9	
5604	10-4	
5605	10-54	
5606	10-1	

BLISTER PACKED SEALS (2/PACK)

BEARING PROTECTION

BEARING BUDDIES, BEARING BUDDY COVERS

STAINLESS STEEL

WHEEL BEARING PROTECTOR

- Provides permanent protection against damage from water and dirt entering the wheel bearing.
- Prevents corrosion resulting from water entering the hub when the trailer wheels are suddenly submerged.



MODEL NO.*	OUTER BEARING CONE*	OUTER BEARING CUP*
1781	LM 11949	LM 11910
1810	LM 67049	LM 12711
1938	O9067	O9194, 95, 96
1968	M12649, O7100	M12610, O7196
1980A	L 44643, L 44649, L 44640	L 44610
1980T Threaded	L 44643, L 44649, L 44640	L 44610
2047	Various	O7204
2240	1700 Series	1729
2328	LM 67048, Hub Not Counterbored	LM 67010
2441	LM67048, Hub Counterbored & others 15133	LM67010, 15245
2562	48548	48510
2717	14124, 14125A	14276

SPINDO® SEAL

For use with pressurized bearing protectors on trailers with brakes or as replacement seals.

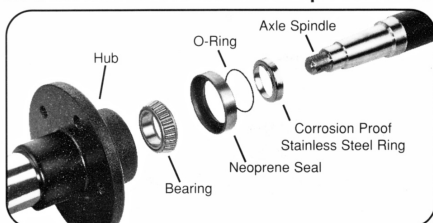

Spindo Seal is a high quality seal system designed to end grease leakage. Seals will last many years because they ride on a permanently smooth, corrosion - proof surface constantly greased by the action of the pressurized bearing protector.

BEARING-LIFE BEARING PROTECTOR COVER SIZES

17B	Fits 1.781" or 1.180" Diameter (BP 178)
19B	Fits 1.980" Diameter (BP 198)
23B	Fits 2.328" and 2.441" Diameter (BP 232 & 234)

* Sizes are hub dust cover bore diameter in inches.

SPINDO-SEAL SIZES

MODEL NO.	USE WITH	INNER BEARING	SEAL DIAMETER
BBY1	1980	L44643	1.98"
BBY2	1980, 1968	LM48548, L68149	2.56"
BBY5	1980	L44649	1.98"
BBY10	1810	68149	1.718
BBY11	2441	25580	3.38"

WHEEL AND HUB PARTS



WHEEL STUDS-DRIVE IN

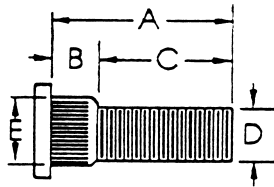

PART#	MFG.	L = A	TL = C	K=E	TS = D	KL = B
7-122	DEX	1 7/8"	1 1/8"	5/8"	1/2"	5/16"
7-123	H/A	2 1/2"	1 1/16"	17/32"	1/2"	9/16"
7-124	H/A	1 13/16"	1 1/4"	9/16"	1/2"	1/2"
7-246	DEX	1 3/4"	1 3/16"	1/2"	1/2"	1/4"
D40368	DICO	2"	1 3/16"	9/16"	1/2"	11/16"
7-132	DEX	2 1/4"	1 1/4"	11/16"	9/16"	1/4"
7-115	DEX	3 1/8"	1 3/4"	11/16"	5/8"	1/4"
7-262	DEX	2-1/2"	1-1/8"	9/16"	1/2"	1-3/8"
71-295	same as DEX7-122, 6 per blister card					

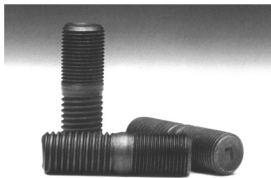

WHEEL STUDS-SCREW IN

PART#	DESCRIPTION
25-11	9/16"-12 x 9/16-18 (coarse/fine), 3.06" length
25-14	1/2"-13x1/2"-20(coarse/fine), DISCONTINUED, use 7-36 instead



WHEEL BOLTS

PART#	DESCRIPTION
7-40	1/2"-20 RH thread w/ 13/16"hex, 1 1/4" length
5787	1/2"-20 RH thread w/ 13/16"hex, 1 1/4" length
7-41	9/16"-18 thread w/ 13/16"hex, 1 1/4" length, DISCONTINUED

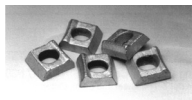

RIM CLAMPS, RIM CLAMP BOLTS

PART#	CLAMPS DESCRIPTION
15-2	standard 14.5" open rim clamp, use with all 1/2" or 9/16" wheel bolts or studs
5790	same as 15-2, 5 per blister pack



PART#	BOLTS DESCRIPTION
7-36	1/2"-13 RH thread w/ 7/8"hex, 1 5/8" length
5791	1/2"-20 RH thread w/ 7/8"hex, 1 7/8" length, 5 per blister pack
5792	same as 7-36, 5 per blister pack
5793	1/2"-13 RH thread w/ 7/8"hex, 2 5/16" length

REPLACEMENT WHEEL NUTS

PART#	DESCRIPTION
5580R	7/16"-20RH conical seat wheel nut, 60' taper, 3/4" hex
6-80	1/2"-20RH conical seat wheel nut, 60' taper, 13/16" hex
6-12	1/2"-20RH flat face, rim clamp nut, 7/8"hex
6-53	9/16"-18RH conical seat wheel nut, 60' taper, 7/8"hex
6-5	9/16"-18RH flat face, rim clamp nut, 7/8"hex
5892	9/16"-18RH 1 pc. flat flanged wheel nut, 7/8" hex
4975R/L	5/8"-18RH or LH conical seat wheel nut, 90' taper, 1 1/16" hex
5652R/L	3/4"-16RH or LH conical seat wheel nut, 1 1/2" hex
7895R/L	3/4" -16 inner thread x 1 1/8"-16 outer thread RH or LH "inner Budd" nut
5552R/L	1 1/8"-16 RH conical seat "outer Budd" nut, 1 1/2" hex



WHEEL MOUNTING PLATES-TRUCK AND TRAILER

PART#	DESCRIPTION
33-52-1	Wheel clamping plate for dual type trailer wheels, 8 hole- 6 1/2" bolt circle (use E4975R/L lug nuts with this clamping plate). Also used with GM/Chevy 16" and 16.5" dual wheels